

THE BOX

**YOUR NEW
VENUE FOR
CORPORATE
EVENTS**

A STATEMENT SPACE IN A UNIQUE SETTING

The Box ticks all of the boxes to guarantee your next event, whether it's a seminar or a catwalk show, will be a real talking point. Please contact us to secure your dates and discuss how we can make your next event the best yet.



**Multi-purpose
+ versatile space**



Floor Space

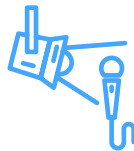

**AV & lighting
equipment**



High Speed WiFi



**Independent
businesses**



**Catering
& bar**



**Assistance from
our on-site team**



**Disabled
access**



**Adjacent to
Coventry city
& University**



**Hearing
Loop zone**



**Changing rooms
with shower**

THE BOX

Our versatile main space is fully equipped with a host of features, including lighting, video and ventilation, to ensure the venue is ready to let your imagination run wild! We recommend The Box for: Corporate events, exhibitions and product launches, live music and performance.



250SQM

Floor
Space



Warehouse
Style Space

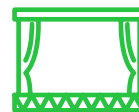

Staging



5.5M

Ceiling Height



Blank Canvas



Versatile Venue



3 Phase Power



High Speed WiFi



THE FOYER

The Foyer has been designed to create a welcoming entrance space to facilitate a fast event registration, break out space or standalone event space. We recommend The Foyer for: Networking, informal meetings, parties, live music (acoustic), screenings and talks.

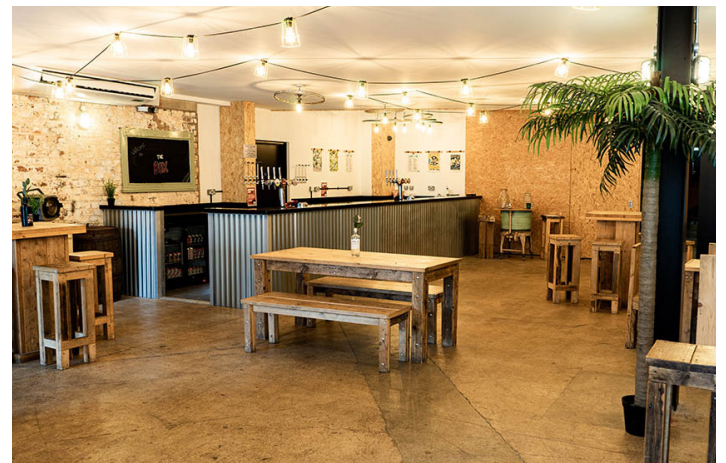

Blank Canvas



Food Service
Area



Multi-purpose
+ versatile space



Serviced Bar



Ticket Office



Washrooms

FLOOR PLAN

THE BOX

THE FOYER

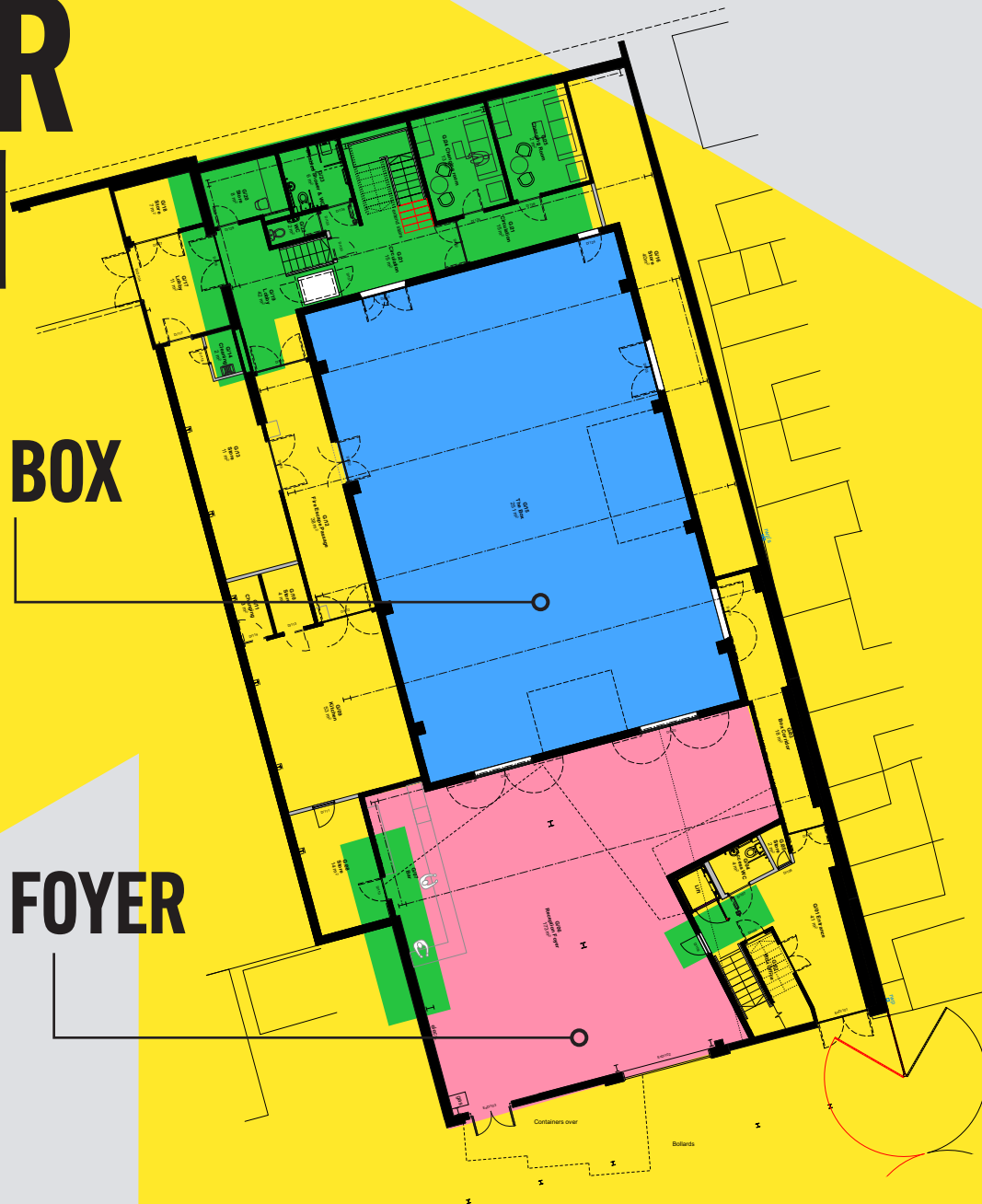

SPECIFICATIONS



TECHNICAL SPECIFICATIONS

The Box features a wide range of facilities to accompany your event. For a sound / lighting package quote, please enquire at the venue.

STAGE

Flexible performance space with wheelchair accessible stage.

Dimensions from:
3m(w) - 12m(w)

Heights of:
400mm & 750mm.



**Wheelchair
Accessible
Stage**

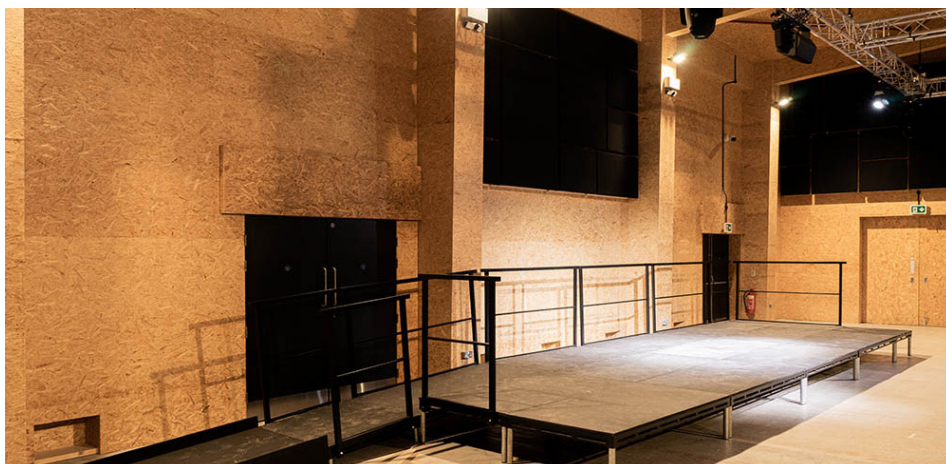

AUDIO SPECIFICATION

Flexible sound system to cater for your presentations and performances.

LIGHTING/VIDEO SPECIFICATION

Fully automated lighting system providing a range of looks and feels, as well as lighting for performance and presentation.

Video projection with flexible screen size and location.

Contact us to discuss your specific AV requirements at thebox@fargovillage.co.uk.

LAYOUTS

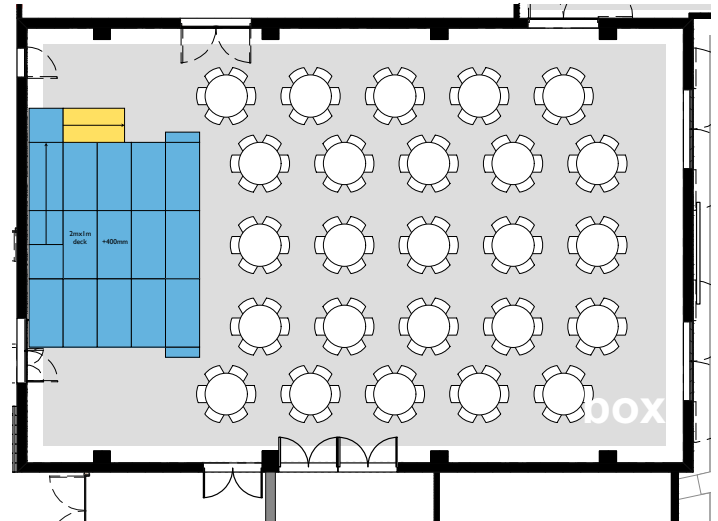
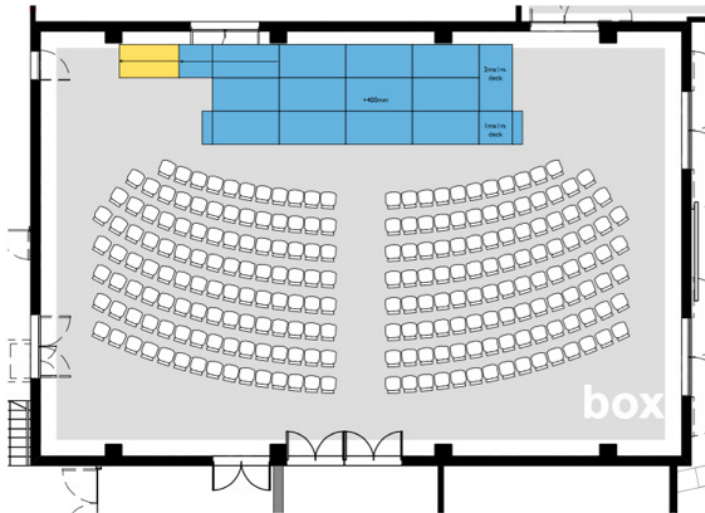
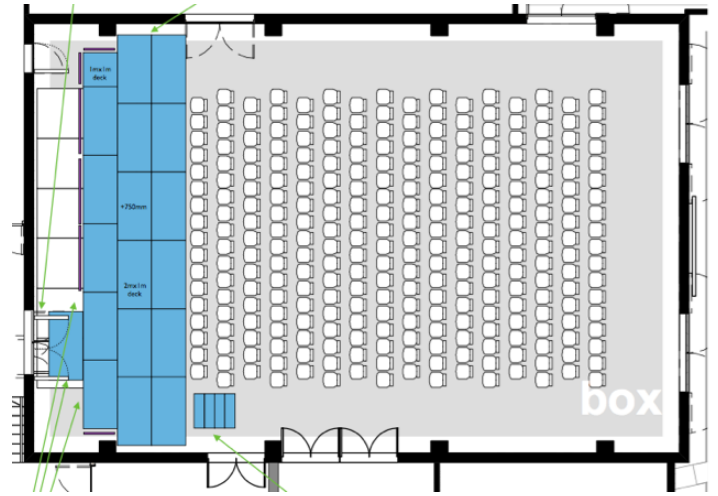
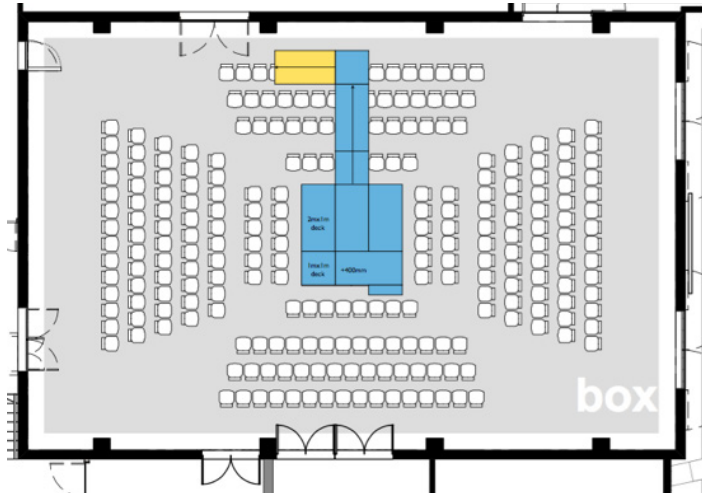

RATES & PACKAGES

We offer a flexible bespoke selection of packages and can also provide quotes for Room Hire only (subject to availability).



Max Capacity Based on Layout	Theatre	Cabaret	Banquet	Board Room	Class-room	U-Shape / Table	Drinks Reception
The Box (Inc Stage)	250	77	140	Custom	100	51	500
The Foyer (No Stage)	80	25	50	36	33	42	200

DAY DELEGATE PACKAGE FROM £30 (PLUS VAT) PER PERSON



Hire Between 9am & 6pm



Projection, LCD + Sound



High Speed WiFi



Flip Chart + Pens



Unlimited Tea + Coffee



Buffet Lunch (or alternative)

OPTIONAL EXTRAS



Early Starts + Breakfast



Staging + Setup



Evening Dinner



Changing room with shower



AV & lighting equipment



Breakout Spaces

CONTACT US

Please contact us to discuss the requirements for your next event.
THEBOX@FARGOVILLAGE.CO.UK | 024 76252434



VIRTUAL & HYBRID EVENTS

With the increasingly popularity of virtual and hybrid events, we can offer a flexible range of in person events seamlessly linked with virtual content, streaming and presentations.

Our in-house technology and technical support ensure that a memorable experience is created, with a wide reach and participation. We can support you in arranging your event, talk to us about our options and cost-effective packages.



CATERING YOUR EVENT

At The Box we're flexible with our catering and are able to find the right catering for you and your conference. Whether it be independent gourmet food, street food or catering for 200 +, we will have the right packages available for you.

Our Food Hall, The Factory has delicious street food options and our on-site craft brewery is always a popular choice at the end of a busy day.



TEAM BUILDING

We like to think of ourselves as offering something a little different to the norm - we can offer activities from chocolate making to art and animation classes to mediation, escape rooms, beer making and more.

We have relationships with many other local attractions, restaurants and services to make your event very special and memorable.

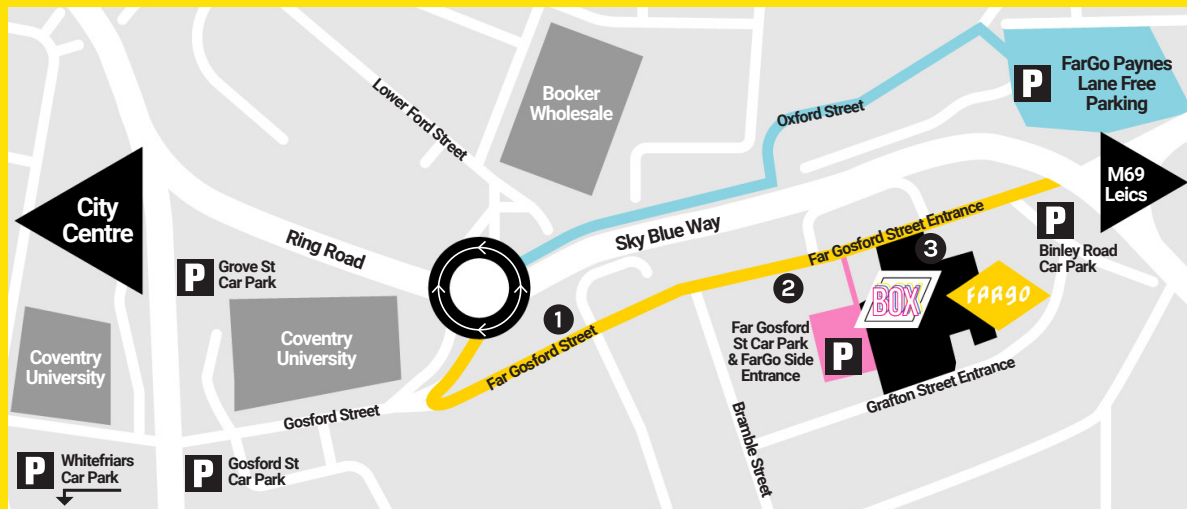

FIND US

- 1 Sainsbury's
- 2 Domino's Pizza
- 3 FarGo Entrance

ACCESS & PARKING

There are 6 car parks within a half mile / 10 minute walk of FarGo Village. We're also situated on 2 major bus routes (all the details are on our website) and we've got plenty of bicycle parking too.

On event days, we strongly recommend you do not attempt to drive up Far Gosford Street as it can get extremely busy. Please try Paynes Lane car park or any of the City Centre Council car parks.

FAR GOSFORD STREET CAR PARK

Far Gosford Street, CV1 5DZ

Spaces: 18

Charges: Mon-Sat 8am-6pm

Blue Badge holders may park free

Please note a section of this car park is designated as "private" and is not available for public parking during office hours Monday - Friday. Parking here will result in a fine. Warning signs are clearly displayed.

BINLEY ROAD CAR PARK

Spaces: 22

2 hours free parking with ticket

FARGO PAYNES LANE PARKING

Paynes Lane, CV1 5LN

Spaces: 97

Free on evenings and weekends

Weekdays 2 hours free

WHITEFRIARS, GROVE STREET & GOSFORD STREET CAR PARKS

Combined spaces: 469

Charges: Mon-Fri 8am-6pm

Saturdays, Sundays, Evenings and Bank Holidays: £1 all day

Blue Badge holders may park free



FARGO

[@TheBoxAtFarGo](https://twitter.com/TheBoxAtFarGo)
[@TheBoxAtFarGo](https://facebook.com/TheBoxAtFarGo)
[@TheBoxAtFarGo](https://instagram.com/TheBoxAtFarGo)
www.fargovillage.co.uk/the-box - FarGo Village, Far Gosford Street, Coventry, CV1 5ED

With support from



Coventry & Warwickshire
Local Enterprise Partnership



2021 CLUB MEMBER